

FordKa
Quick Start

Feel the difference



DASHBOARD (LEFT-HAND DRIVE)

The presence and position of the controls, the instruments and the indicators may vary according to the versions.

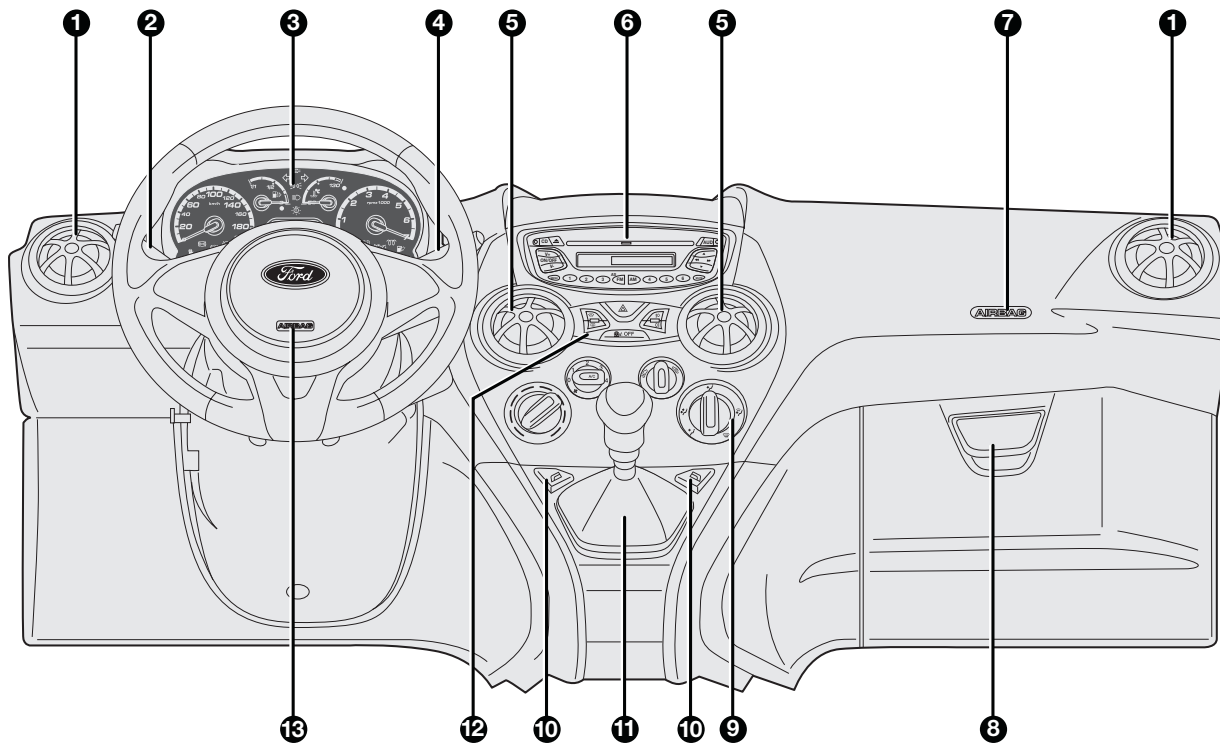

KA0001m

1. Side vent – 2. Left stalk: external lights control – 3. Instrument panel and warning lights – 4. Right stalk: controls wiper, washer, trip computer – 5. Central air vents – 6. Oddment/Car radio compartment – 7. Passenger side airbag – 8. Oddment compartment/hidden document tray – 9. Heating/ventilation/climate control – 10. Power windows control – 11. Oddment compartment – 12. Gear lever – 13. Driver side airbag.

DASHBOARD (RIGHT-HAND DRIVE)

The presence and position of the controls, the instruments and the indicators may vary according to the versions.

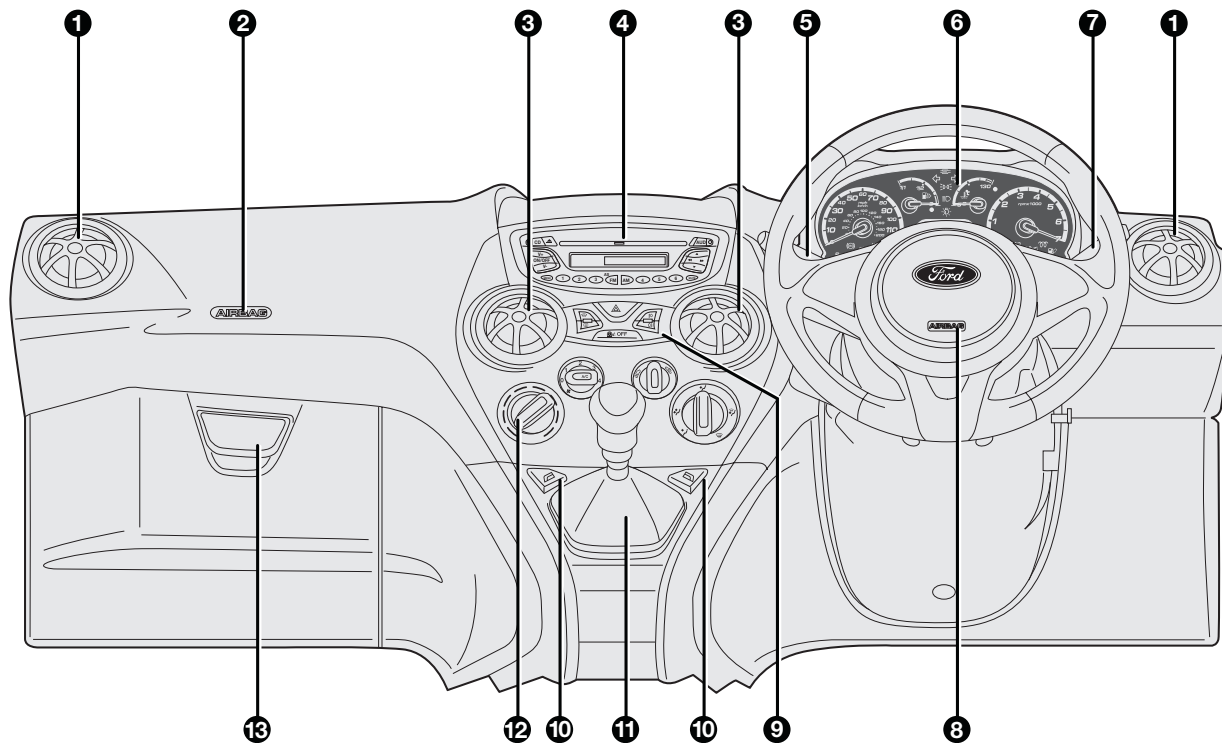

KA00112m

1. Side air vent – 2. Passenger side air bag – 3. Central air vents – 4. Oddment/radio compartment – 5. Left stalk: external lights control – 6. Instrument panel and warning lights – 7. Right stalk: controls windscreen wiper, rear wiper, trip computer – 8. Driver's Air bag – 9. Control panel – 10. Power window control – 11. Gear lever – 12. Heating/ventilation/climate control – 13. Oddment compartment.

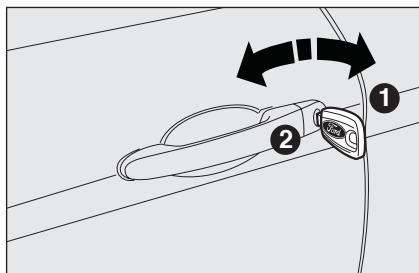

KA00033m

DOORS

LOCK/RELEASE FROM OUTSIDE

To open

Rotate the key to **1** and pull the handle upward.

With remote control (where provided), press the button  to open the doors.

To lock

Rotate the key to **2** with fully closed door.

With remote control (where provided), press the button  to close the doors.

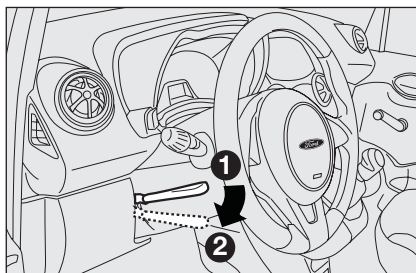

KA00113m

STEERING WHEEL

It can be adjusted vertically (where provided).

For adjustment, bring the lever downward to position **2** then position the wheel and lock it bringing lever to position **1**.

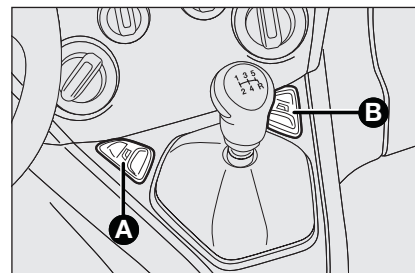

KA00035m

FRONT WINDOW WINDERS (where provided)

The two buttons are located besides the gear lever (one for each side):

- A** to open/close the left front window;
- B** to open/close the right front window;

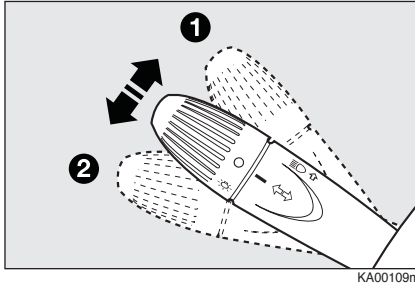

KA00109m

EXTERNAL LIGHTS

The left-hand stalk operates most of the external lights. The external lights can only be switched on when the ignition key is on **MAR**. The instrument panel and the various controls on the dashboard will come on when the external lights are switched on.

LIGHTS OFF

Knurled ring turned to symbol .

SIDE LIGHTS

Turn the knurled ring to position .

DIPPED BEAMS

Turn the knurled ring to position .

MAIN BEAMS

With knurled ring in position , push the stalk forward toward the dashboard (steady position).

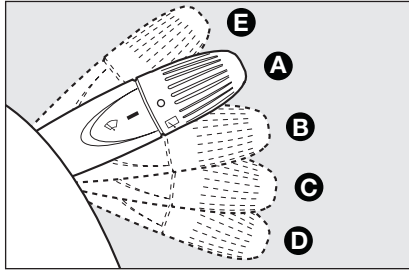

KA00111m

FLASHING

You can flash the beams pulling the stalk toward the wheel (unstable position).

DIRECTION INDICATORS

Push the stalk to (stable) position:

up (position **1**): right-hand indicator ON;

down (position **2**): left-hand indicator ON.

WINDOW WASHING

WINDSCREEN WASHER/WIPER

The stalk has 5 different positions (4 speeds):

- A** windscreen wiper off.
- B** intermittent.
- C** continuous slow.
- D** continuous fast.
- E** temporary fast (unstable position).

“Smart washing” function

Pull the stalk towards the steering wheel (unstable position) to operate the windscreen washer jet.

REAR WINDOW WIPER/ REAR WINDOW WASHER

Turn the knurled ring to  to operate the rear window wiper.

Pushing the stalk towards the dashboard (unstable position) will activate the rear window washer.

MANUAL CLIMATE CONTROL SYSTEM

- A** Air temperature knob (red-hot / blue-cold).
- B** Fan speed knob and climate control system activation/deactivation.
- C** Air recycle knob.
- D** Air distribution knob.
- E** Heated rear screen activation/deactivation button.
- F** Heated rear screen activation/deactivation button.

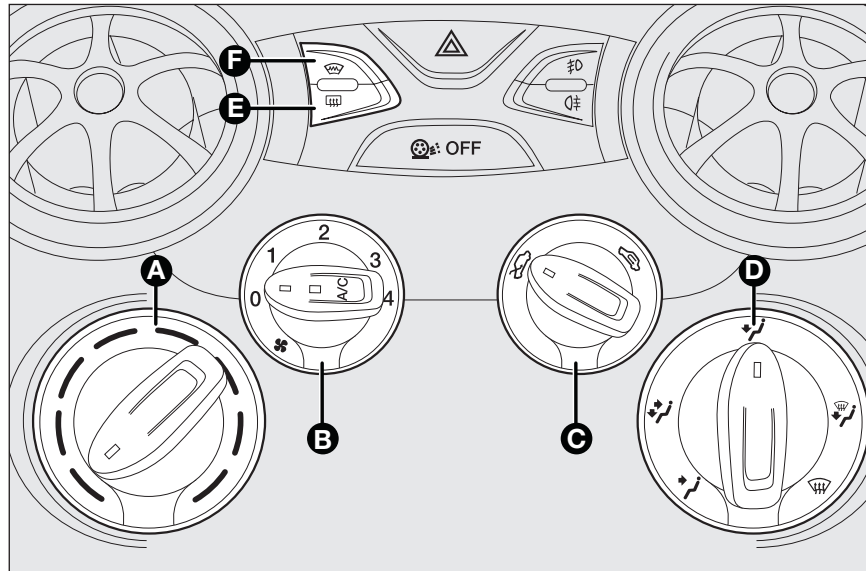

KA00027m

QUICK START

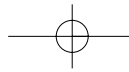

AUTOMATIC CLIMATE CONTROL SYSTEM

Button AUTO - A
Activation of the automatic function of the climate control system

A/C button - B
compressor activation/deactivation

Button OFF - C
System switch off

Button  - D
Air recycle on/off button

Buttons +, -, E
Setting desired temperature

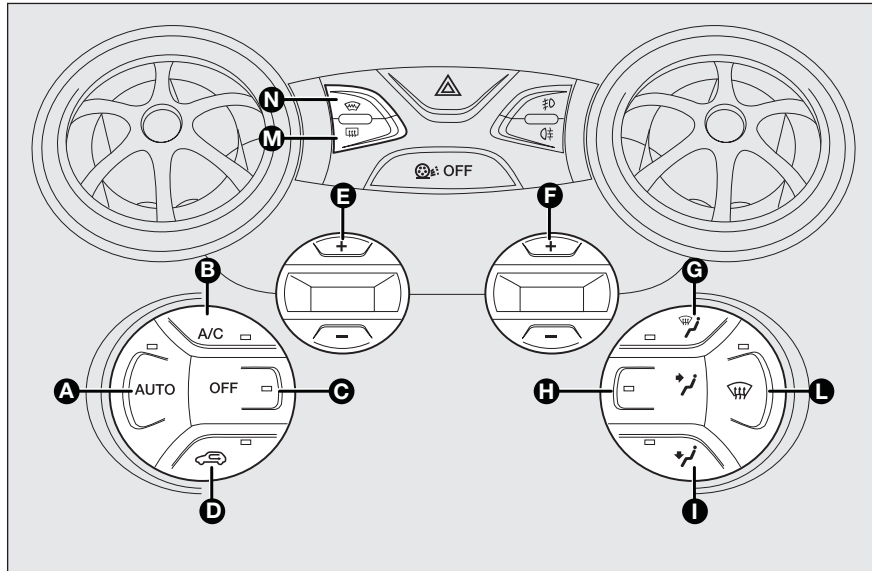

KA00028m

Buttons +, -, F
Adjusting fan speed

Buttons  - G H I
Manual air distribution selection

Button  - L
Front window fast demisting/defrosting button

Demisting/defrosting heated rear window

Press button **M** to activate this function.

Demisting/defrosting heated rear window

Press button **N** to activate this function.

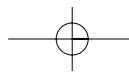

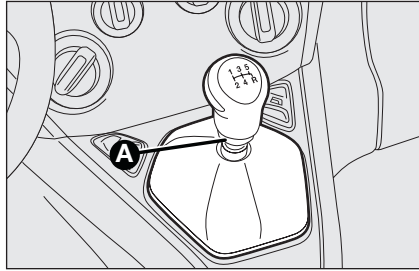

KA00060m

USING THE MANUAL GEARBOX

To engage the gears, press the clutch pedal fully and shift the gear lever into one of the required positions (the diagram is shown on the knob).

To engage reverse **R** from neutral, raise ring **A** under the knob and at the same time move the gearshift lever rightwards and then backward.

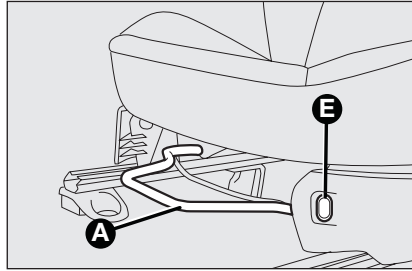

KA00006m

SEATS

FRONT SEATS

Fore/aft adjustment

Lift lever **A** and push the seat forwards and backwards.

Heated seats

Press button **E** to switch the seat warming on/off.

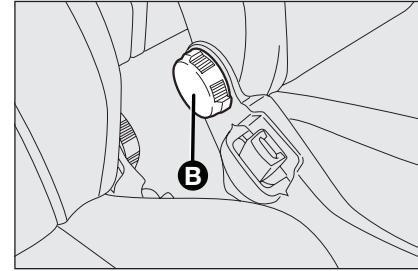

KA00007m

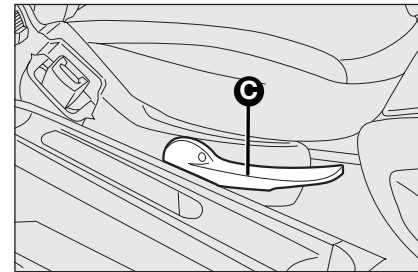

KA00008m

Back rest angle adjustment

Turn knob **B**.

Seat height adjustment

Operate lever **C** to lift or lower the rear area of the cushion to achieve the most comfortable driving position.

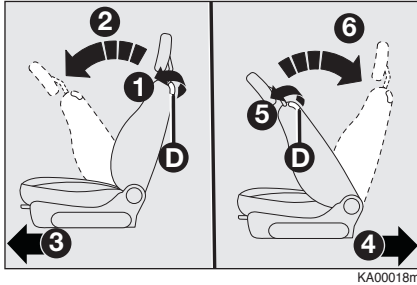

Backrest tilting

To tilt the seat, operate lever **D** (movement **1**) and push the backrest forward to lock (movement **2**); release lever **D** and push the backrest to slide the seat forward (movement **3**, applies only to seats with easy entry).

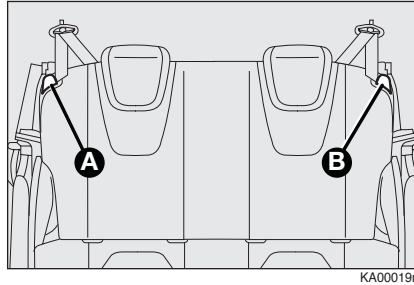

REAR SEATS

Backrest release

- For versions with joint seat, lift handles **A** and **B** and guide the backrest onto the cushion.
- For versions with separate seats, lift handle **A** or **B** to release respectively the left or right part of the backrest and guide the backrest onto the cushion.

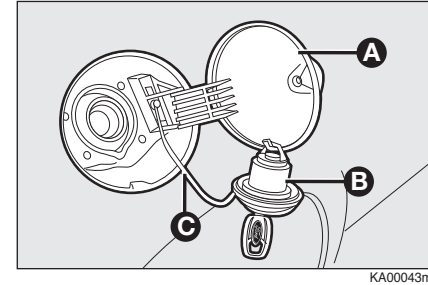

FUEL FILLER CAP

The cap **B** is provided with a loss prevention device **C** which secures it to the lid **A**.

Unscrew cap **B** using the ignition key.