

[Manual Table of Contents](#)

Class 1 Trailer Tow 4-Pin Wire Harness

CONTENTS

INSTALLATION

[Class 1 Trailer Tow 4-Pin Wire Harness](#)

INSTALLATION

Class 1 Trailer Tow 4-Pin Wire Harness

Special Tool(s)

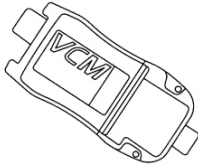
 <p>ST2834-A</p>	<p>Vehicle Communication Module (VCM) and Integrated Diagnostic System (IDS) software with appropriate hardware, or equivalent scan tool</p>
---	--

Class 1 Trailer Tow 4-Pin Wire Harness Kit Contents

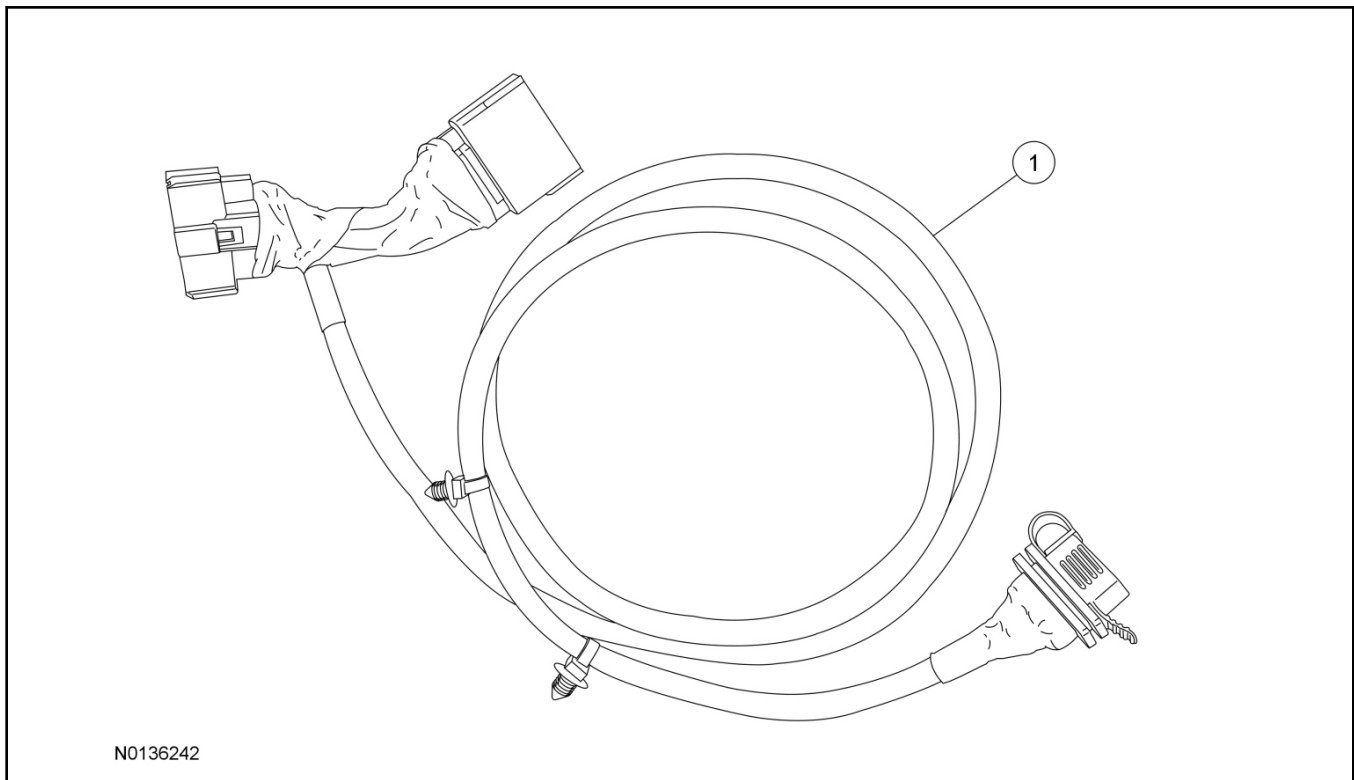

Item	Part Number	Description
1	15436	Class 1 Trailer Tow 4-Pin Wire Harness
2	14E047	Push Mount Cable Tie (Not Shown)
3	17851	14" Cable Tie (Not Shown)
4	18101	8" Cable Tie (Not Shown)

INSTALLATION (Continued)**Vehicle Preparation****NOTE:**

This procedure should be done in combination with trailer hitch installation, as rear bumper cover removal is necessary for both installation procedures.

1. Remove the rear bumper cover. For additional information, refer to Workshop Manual (WSM), Section 501-19.
 - Disconnect electrical connectors C406 and if equipped C405. Connectors C405 and C406 are the black and grey 16-way inline connectors, located behind the passenger side rear wheel well.
 - Place the rear bumper cover on a suitable surface to prevent scratching while installing the trailer tow wire harness.

Installation

2. Position the trailer tow wire harness to the bumper cover. Install the two lower push pin retainers.

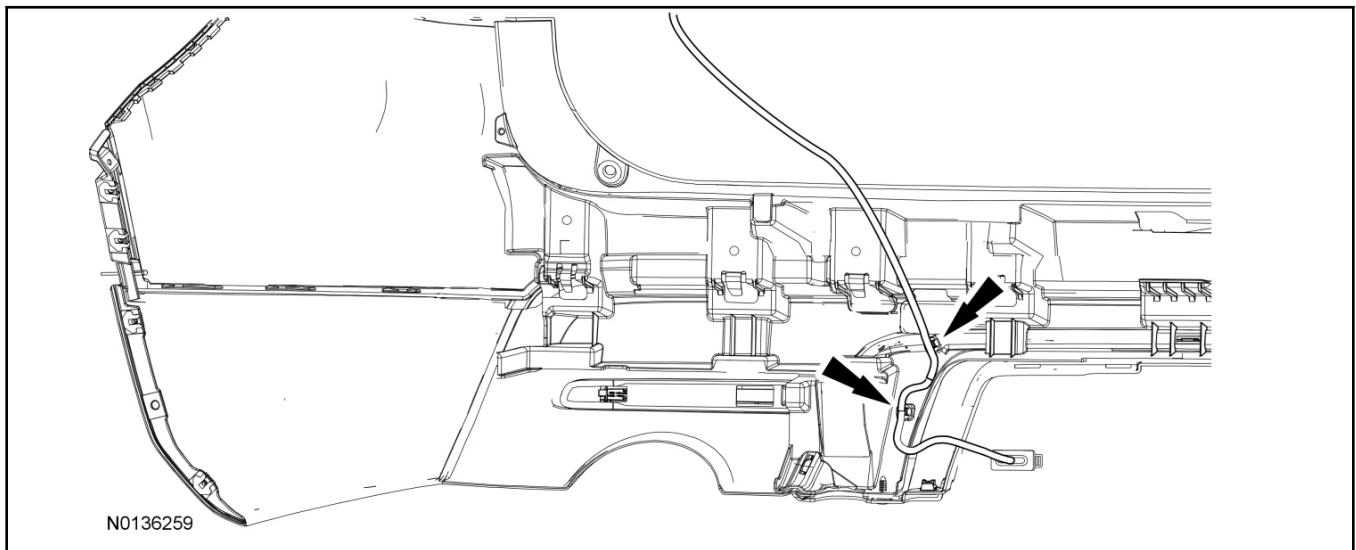
**Vehicles Not Equipped With Parking Aid Sensors**

3. Install the push mount cable ties onto the bumper cover.

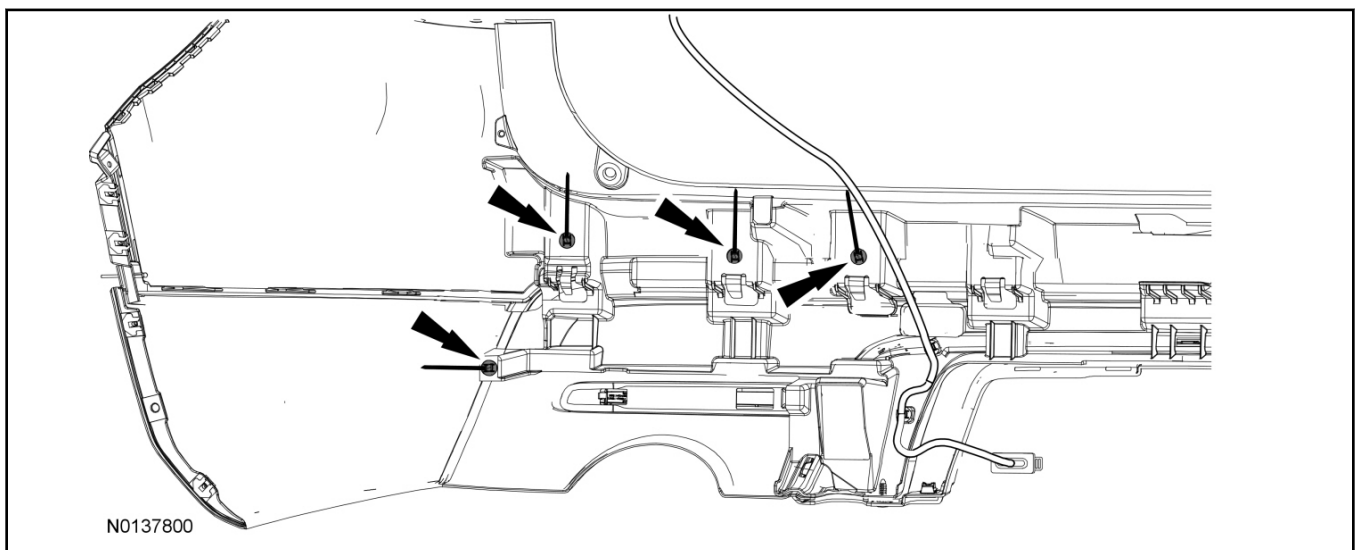

INSTALLATION (Continued)

4. Route and secure the trailer tow wire harness along the push mount cable ties.
5. **NOTE:**
Connector C406 is the black 16-way connector, located behind the passenger side rear wheel well.

Remove the connector cap from vehicle's electrical connector C406.

Install the connector cap onto the male end of the trailer tow wire harness.

Vehicles Equipped With Parking Aid Sensors

6. Secure the trailer tow wire harness to the parking aid sensor harness, using the push mount cable ties.
 - The christmas tree ends of the cable ties are not used for this application.

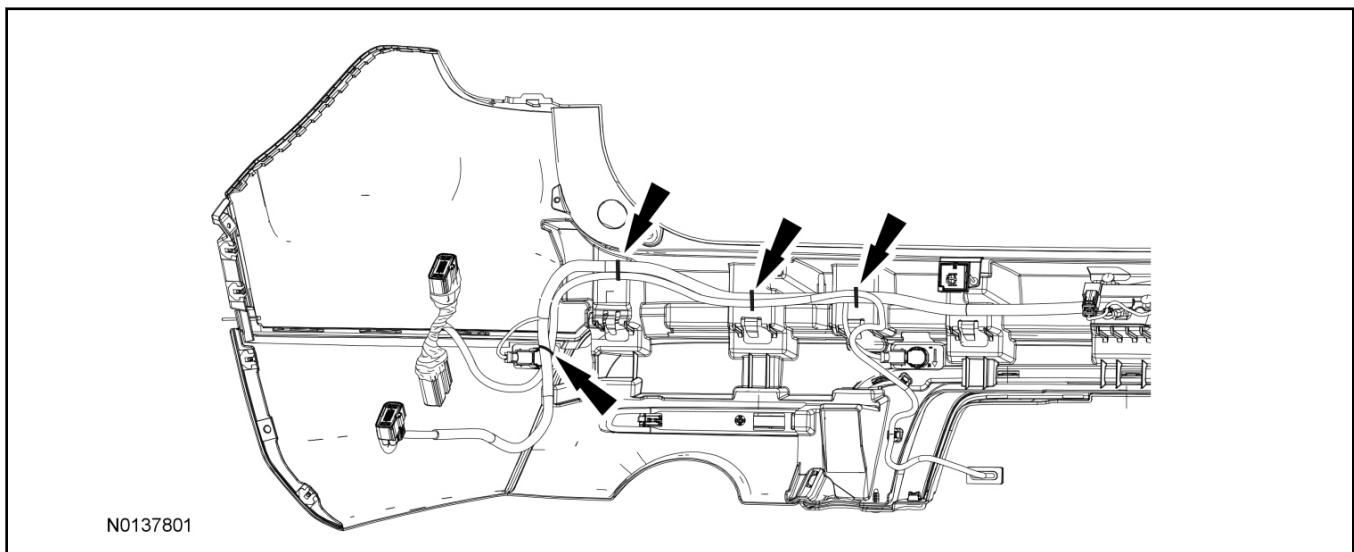

7. Connect the male end of the black 16-way trailer tow wire harness electrical connector to the female end of the black 16-way parking aid sensor wire harness electrical connector.

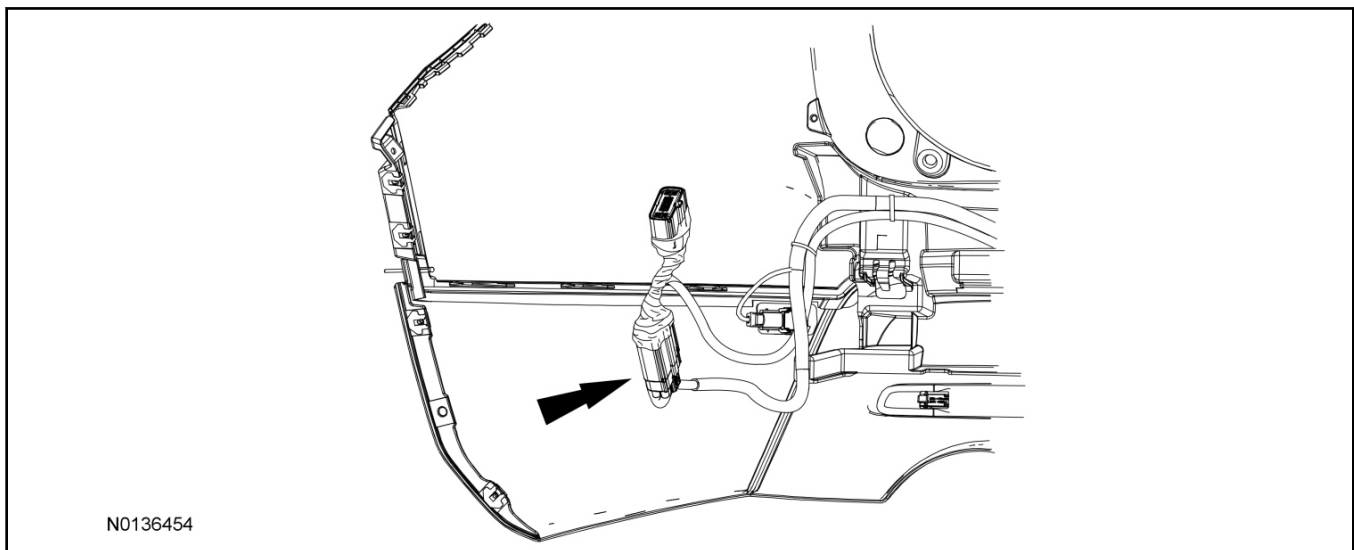

NOTE:
Complete hitch installation at this point.

INSTALLATION (Continued)**All Vehicles**

8. Install the rear bumper cover. For additional information, refer to WSM, Section 501-19.
9. Connect the black 16-way female end of the trailer tow wire harness electrical connector to the vehicle's black 16-way male connector C406.
 - If equipped connect electrical connector C405.
Connector C405 is the grey 16-way inline connector, located behind the passenger side rear wheel well.

All Vehicles

10. Use the 8" cable tie to secure the trailer tow wire harness to the vehicle and away from the muffler.

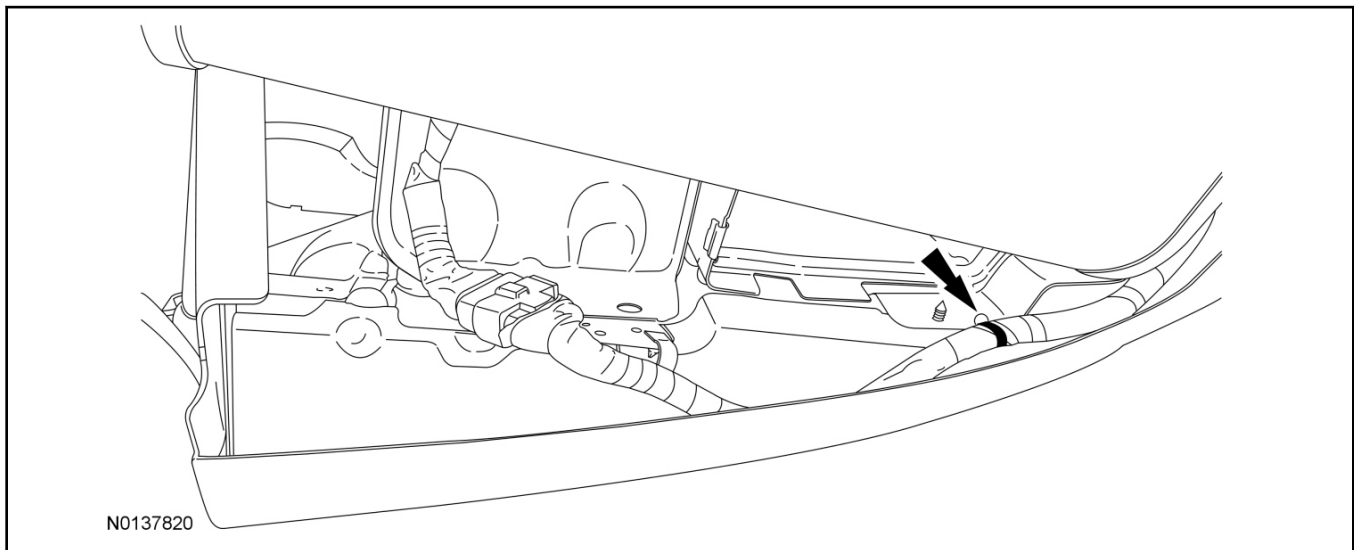

11. Use the 14" cable tie to bundle and secure the 16-way connectors away from the muffler.
12. Install the 4-pin electrical connector onto the hitch bracket.
 - When properly installed the 4-pin connector tab should be pointing toward the driver's side of the vehicle.

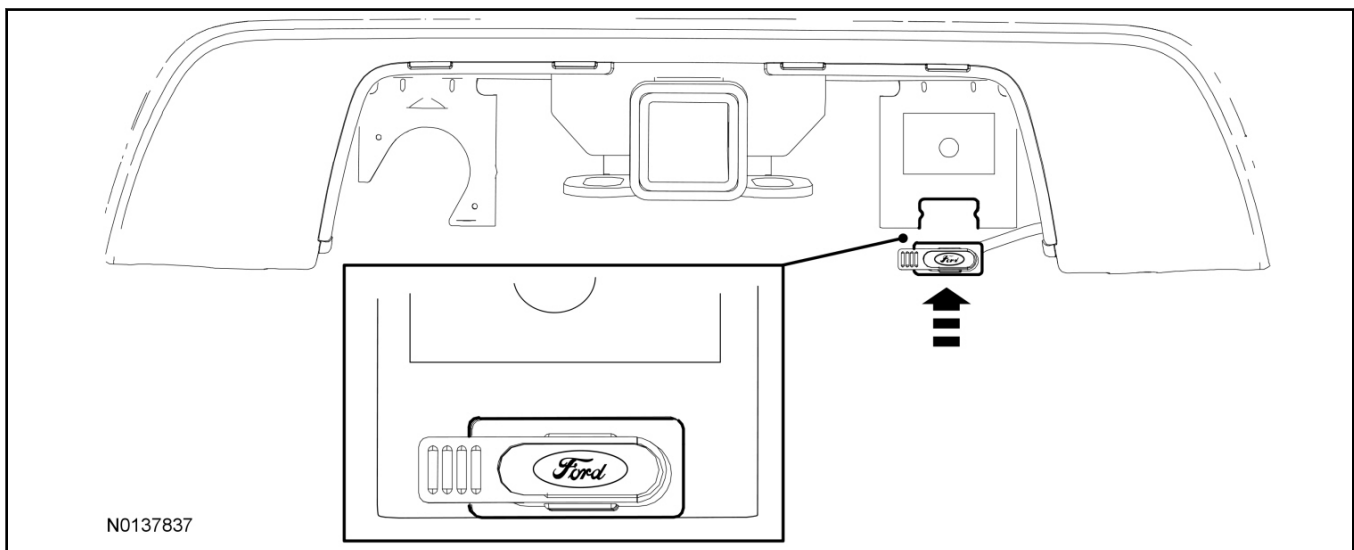

INSTALLATION (Continued)

13. Use the IDS to run a self test. Clear any DTCs generated during installation. Perform self test to ensure no additional DTCs are present.
14. If equipped verify proper operation of the reverse parking aid (RPA) system, blind spot information system (BLIS) and cross traffic alert (CTA) system.
15. Verify proper operation of the 4-pin trailer connector.

NOTE:

When towing a trailer the RPA, BLIS and CTA systems may detect the trailer and cause a false alert.

NOTE:

The class 1 4-pin trailer harness does not support electric trailer brakes.