

Fog Lamp Kit

CONTENTS

INSTALLATION

Prepare Vehicle

Fog Lamp Kit Installation

INSTALLATION**2011 Super Duty Fog Lamp Kit****Special Tool(s)**

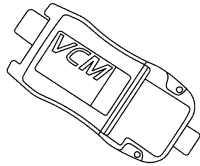
 ST2834-A	Vehicle Communication Module (VCM) and Integrated Diagnostic System (IDS) software with appropriate hardware, or equivalent scan tool
---	---

Fog Lamp Kit**NOTE:**

XL & XLT kit

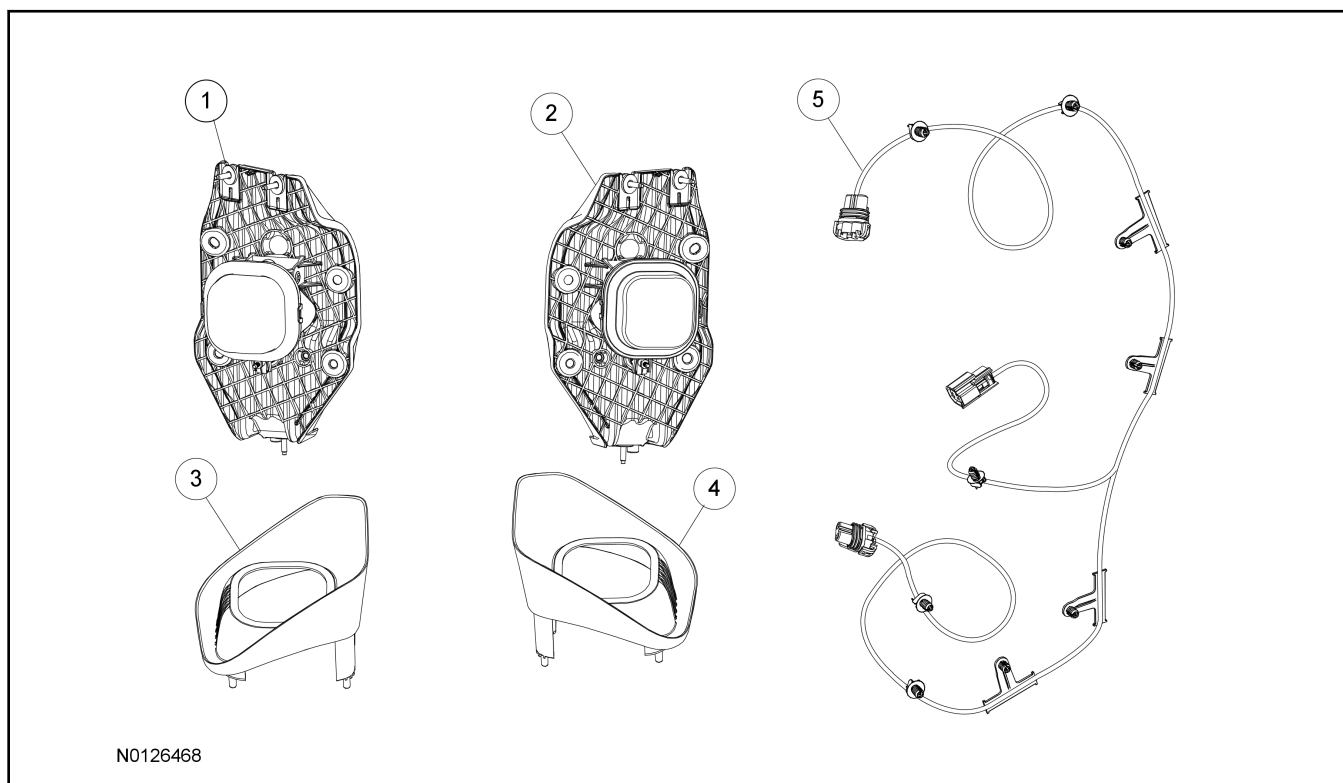

Item	Part Number	Description
1	15A254	RH Fog Lamp Assembly
2	15A255	LH Fog Lamp Assembly
3	15A211	RH Bezel
4	15A211	LH Bezel
5	15A211	Fog Lamp Jumper Wire Harness

INSTALLATION (Continued)

Item	Part Number	Description
6	N801970	Nut (not shown)
7	W623483	Push on Retainer (not shown)
8	W503926	Bolt and Washer (not shown)

NOTE:

XL kit

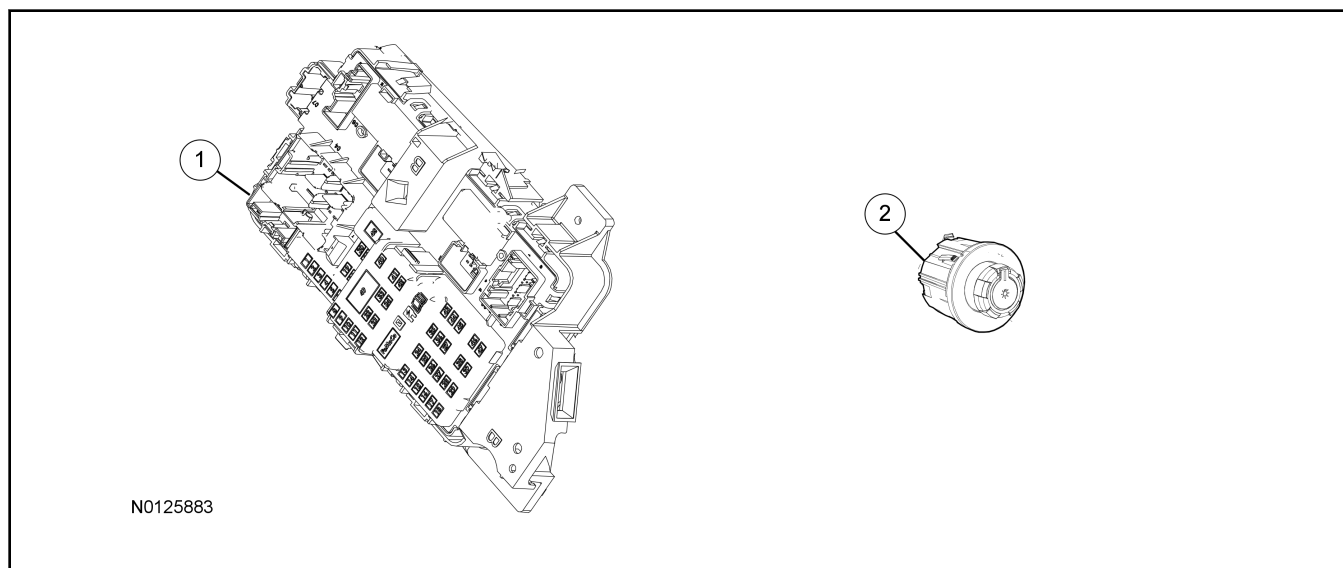

Item	Part Number	Description
1	14B476	Body Control Module (BCM)
2	13D061	Fog Lamp Function Switch

NOTE:

XLT kit

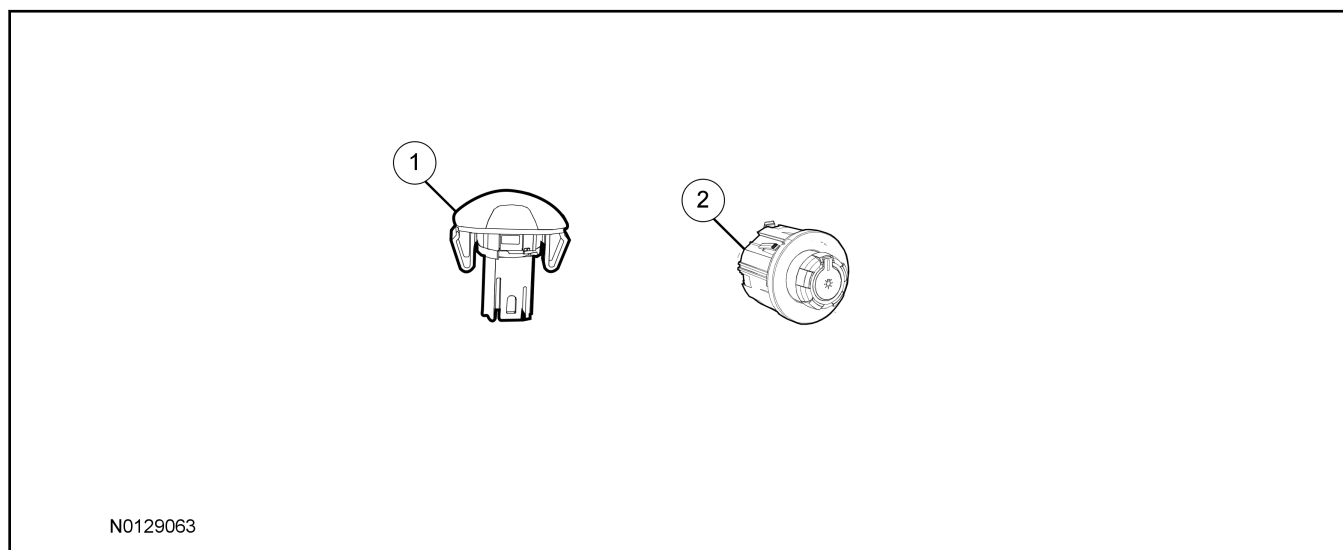

INSTALLATION (Continued)

Item	Part Number	Description
1	13A018	Light Sensor
2	13D061	Fog Lamp & Auto Lamp Function Switch

NOTE:

Both kits will require dealer installation.

NOTE:

XLT installation requires IDS software V72 or higher.

NOTE:

IDS and two Integrated Keyhead Transmitters (IKTs) are required for XL kit installation.

Assemble Fog Lamp Kit**1. NOTE:**

RH side shown, LH similar.

Install the RH and LH bezels onto the fog lamp bracket assemblies.

1 Install the retaining nuts.

- Do not over-tighten.

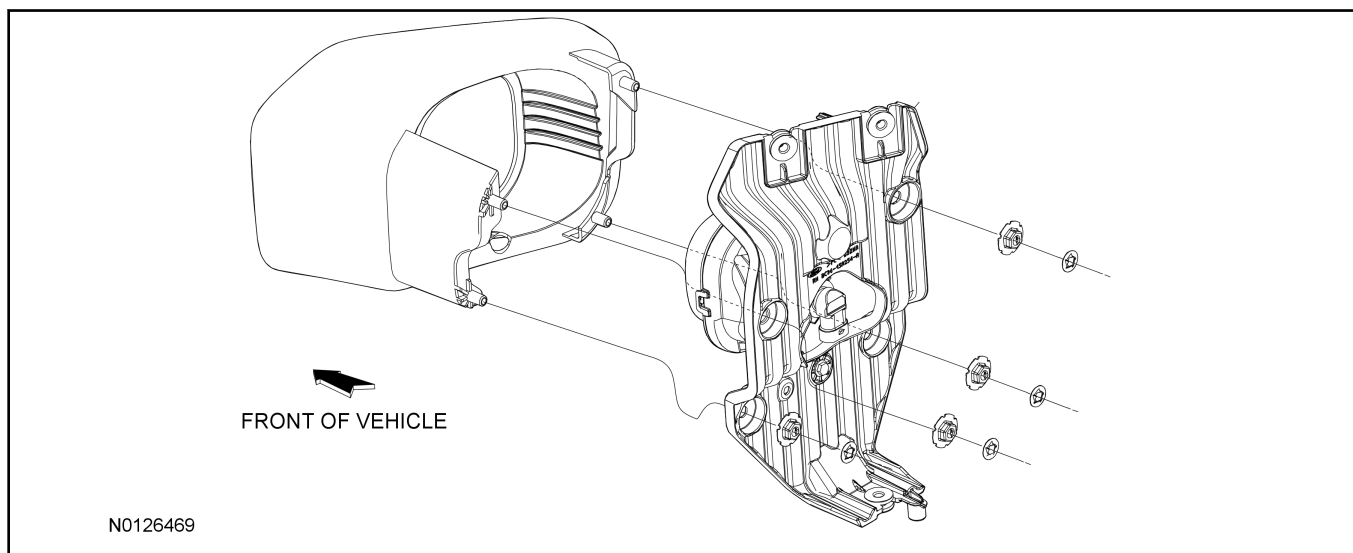
2 Install the push-on retainers.**Vehicle Preparation****2. With the vehicle in NEUTRAL, position it on a hoist. For additional information, refer to WSM Section 100-02.****NOTE:**

Driver side shown, passenger side similar.

3. Remove and discard the front bumper side bezels.

- Remove the 3 retainers.

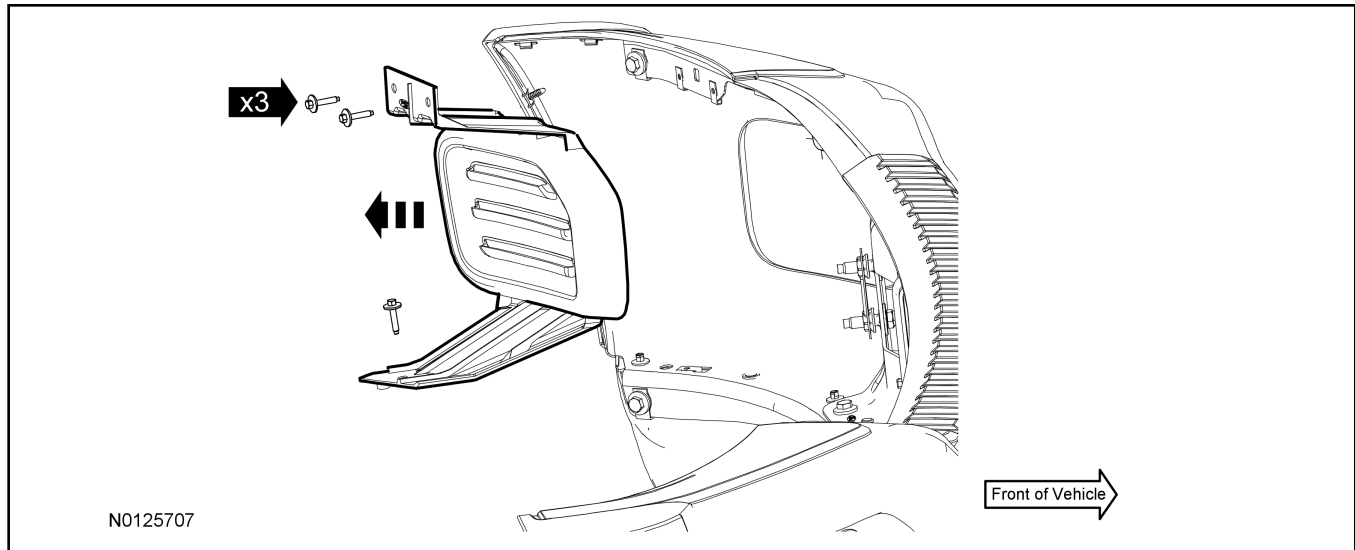
INSTALLATION (Continued)

4. Locate the vehicle's existing fog lamp wire harness connector C134.

- Connector C134 has Black and Brown/Yellow wires.

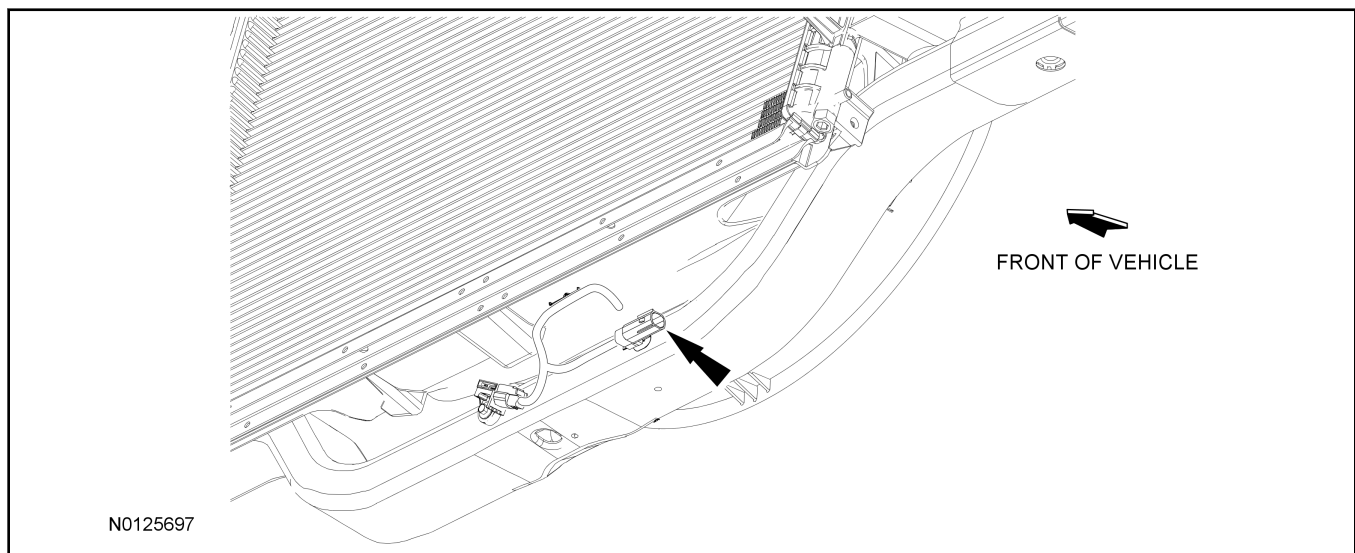

5. If equipped, remove the protective cap from connector C134.

Install Fog Lamp Kit

6. Install the kit-provided fog lamp jumper harness (15A211) to the bumper, and route to the fog lamp mounting areas as shown.

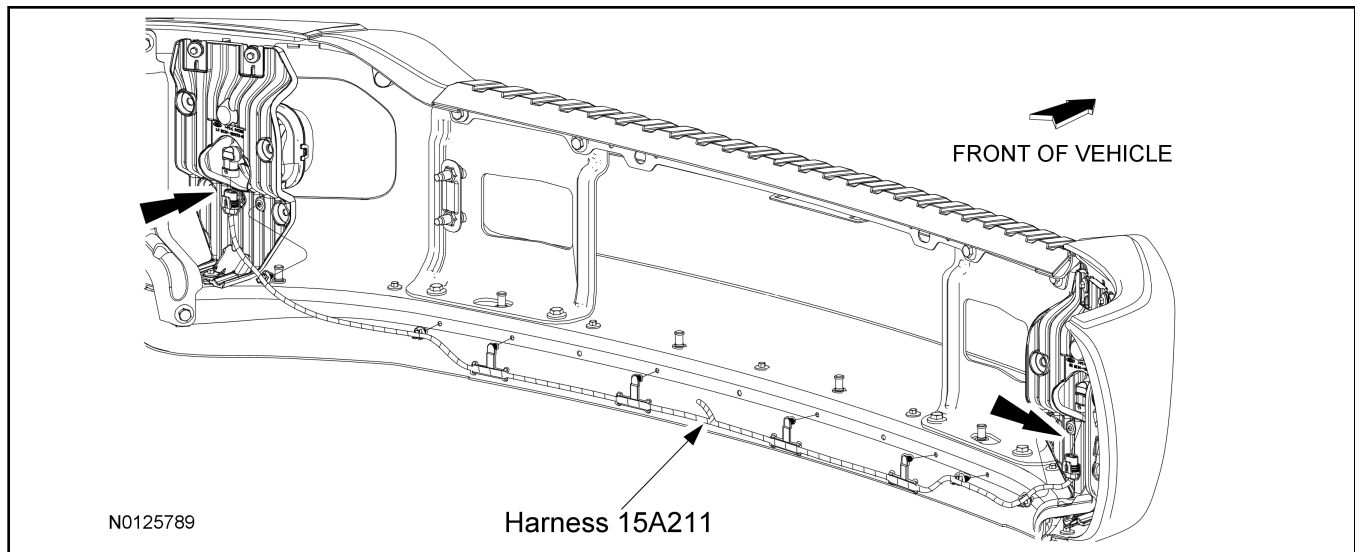
INSTALLATION (Continued)

7. Install the kit-provided fog lamp, bracket and bezel assembly. For additional information, refer to Fog Lamp removal and installation in WSM Section 417-01.

"XL" vehicles

8. Replace the vehicle's existing headlamp switch with the kit-provided fog lamp function switch. For additional information, refer to Headlamp Switch removal and installation in WSM Section 417-01.

NOTE:

A minimum of 2 IKTs devices are necessary to complete the new BCM configuration.

9. Replace the vehicle's existing BCM, with the kit-provided BCM. For additional information, refer to BCM removal and installation in WSM Section 419-10.
10. Verify that the BCM, headlamps and fog lamps operate properly.
 - For BCM troubleshooting concerns or if any related DTCs are present, refer to BCM diagnostics for diagnostic procedures. For additional information, refer to WSM Section 419-10.

"XLT" vehicles

11. Using a suitable tool (such as a pocket screwdriver), remove the light sensor wire harness plug from the instrument panel.
 - Disconnect the electrical connector.

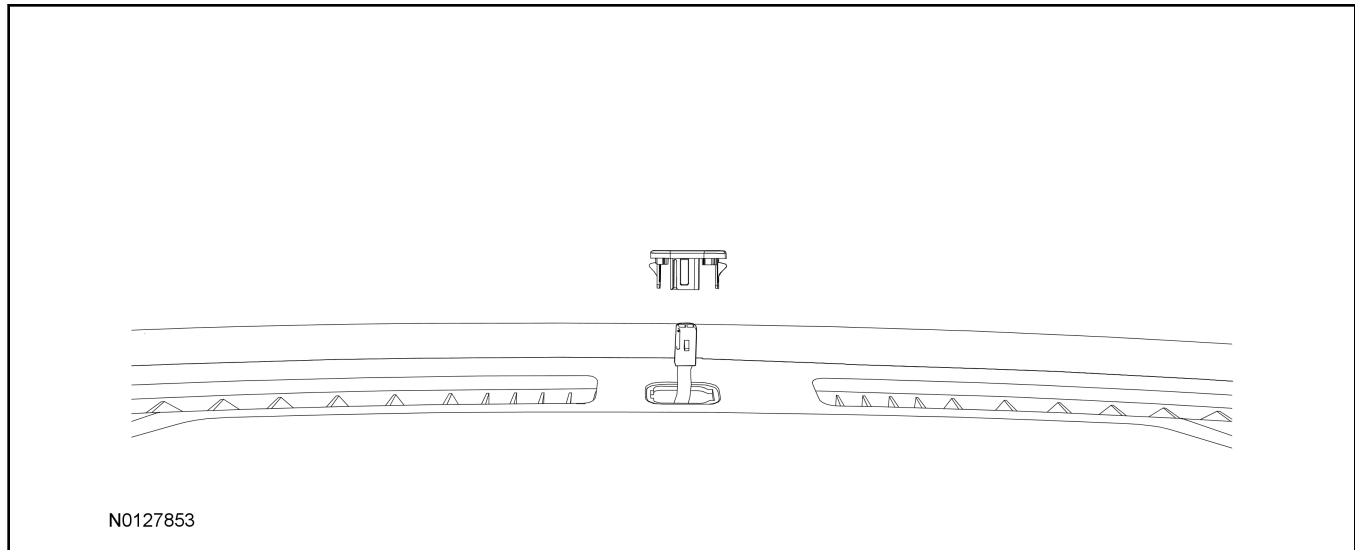
INSTALLATION (Continued)

12. Connect the electrical connector and install the light sensor.

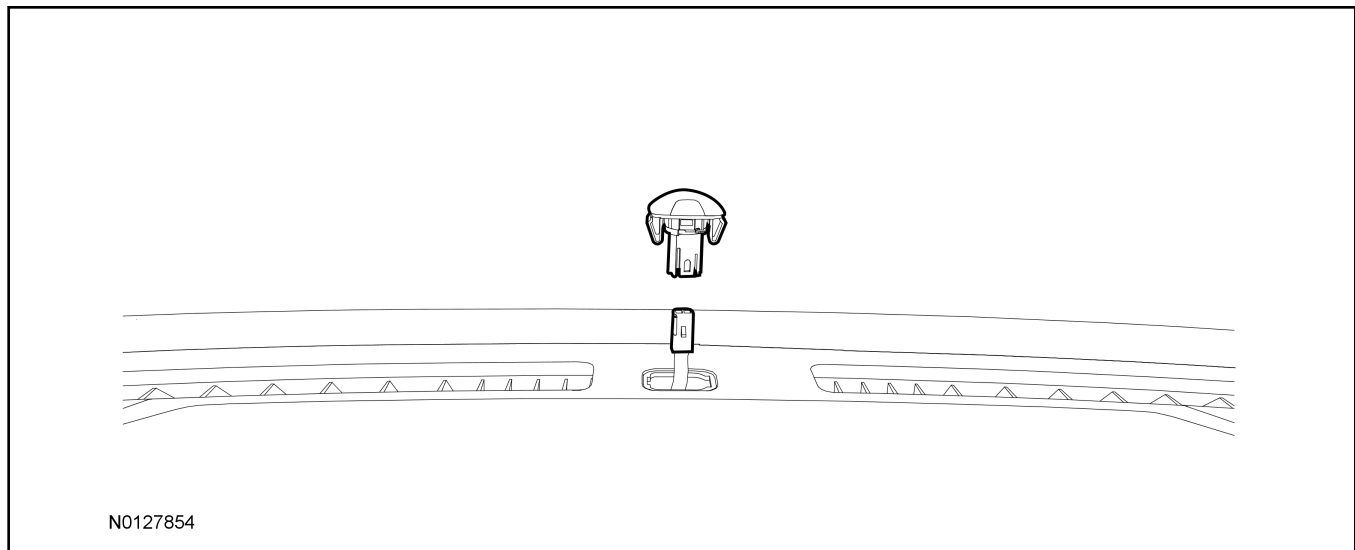

13. Replace the vehicle's existing headlamp switch with the kit-provided fog lamp function switch. For additional information, refer to Headlamp Switch removal and installation in WSM Section 417-01.

All vehicles

14. After Installing the kit provided headlamp switch and light sensor, program the vehicle using the IDS (must use V72 or higher).
- 1 Start a new session and ID the vehicle.
 - 2 Select - Tool Box, then select the following - Module Programming - Programmable Parameters - Exterior Lighting.
 - 3 Select - Ambient Light Sensor - (BdyCM) =.
 - Set to "Present".
 - 4 Select - Auto Lamp Delay Switch - (IC) =.
 - Set to "Enabled".

INSTALLATION (Continued)

- 5 Select - Auto Lamp Delay Switch - (BdyCM) =.
 - Set to "Enabled".
15. After programming is completed, clear any DTCs generated during programming.
 - Perform self test again to ensure that no DTCs are present.
16. Verify that the headlamps, fog lamps and auto lamp function operate properly.